

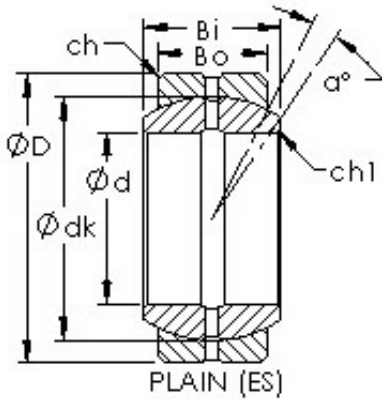

# ISO BEARING-SINGAPORE (PTE)LTD.



## AST GEF150ES plain bearings

Bearing No. GEF150ES

Bore Diameter	150 mm
Outer Diameter	220 mm
Bearing Type - plain-wide	plainwide
Bore Dia (d)	150.0000
Outer Dia (D)	220.0000
Outer Width (Bo)	105.0000
Inner Width (Bi)	120.0000
Dynamic Load Rating (Cr)	1,820,000
Static Load Rating (Cor)	9,140,000
Max. shaft corner radius, or 45 deg. chamfer (ch1)	1.500
Max. housing corner radius, or 45 deg. chamfer (ch)	1.500
Spherical Diameter (dk or Dk)	205.000
Mis-alignment Angle (a deg.)	5
Weight (g)	17,200.00
Material	52100 Chrome steel, or equivalent

GEF150ES Bearing 2D drawings and 3D CAD models