

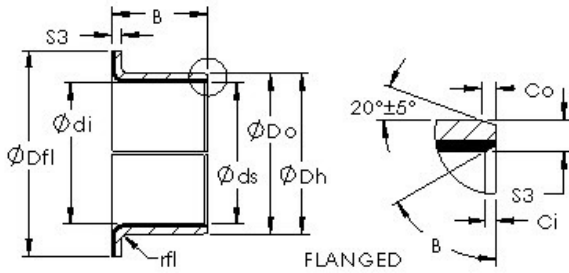

# ISO BEARING-SINGAPORE (PTE)LTD.



## AST AST50 06FIB08 plain bearings

Bearing No. AST50 06FIB08

Bore Diameter	9,525 mm
Bearing Type	flanged
Shaft Dia., Nominal (d)	0.3750
Shaft Size (ds) - 0.374	0.3731
Housing Bore Dia. (Dh) - 0.4691	0.4684
Bearing Bore after Mounting (di) - 0.3769	0.3742
Average Clearance (Cd)	0.0020
Wall Thickness (S3)	0.047
Bearing Length, Nominal (B)	0.500
Bearing Length Tolerance (B tol.) - +.010 / -0.010	+0.010 / 0.010
OD Chamfer Length (Co)	0.023
ID Chamfer Angle (B deg.)	30
ID Chamfer Length (Ci)	0.014
Flange Dia. (Dfl pm 0.5)	0.690
Flange Thickness (Sfl)	0.048
Flange Radius (rfl)	0.040
Material	Carbon steel shell with PTFE / Fiber lining

AST50 06FIB08 Bearing 2D drawings and 3D CAD models