

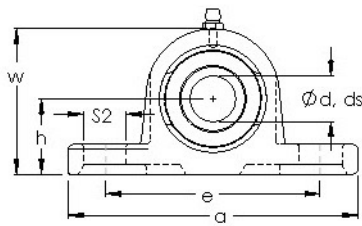

# ISO BEARING-SINGAPORE (PTE)LTD.

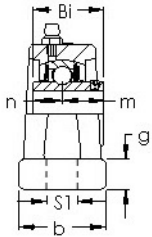

## AST UCP 206 bearing units

Bearing No. UCP 206

UCP 206 Bearing 2D drawings and 3D CAD models

Bore Diameter	30 mm
Bearing Type	Extended inner race with set screws
Dynamic Load Rating (Cr)	19,413
Static Load Rating (Cor)	11,277
Shaft Dia. (Fw)	30.0000
Shaft Height (h)	42.9000
Housing Width (b)	48.0000
Mounting Hole Center-to-Center (e)	121.0000
Housing Length (a)	165.0000
Mounting Slot Length (S2)	21.0000
Mounting Slot Width (S1)	17.0000
Housing Base Thickness (g)	15.0000
Housing Height (w)	84.0000
Bearing Inner Race Width (Bi)	38.1000
Bearing Inner Race Width - Short Side (n)	15.9000
Bearing Inner Race Width - Extended Side (m)	22.2000
Mounting Bolt Size	14.0000
Housing Number	P 206
Shaft Dia., Nominal (d)	30.0000
Weight (g)	1,315.00
Material	Cast iron housing, chrome steel bearing