

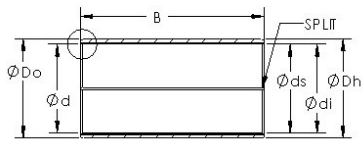

ISO BEARING-SINGAPORE (PTE)LTD.

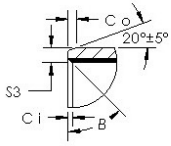

AST AST850BM 2840 plain bearings

Bearing No. AST850BM 2840

AST850BM 2840 Bearing 2D drawings and 3D CAD models

Bore Diameter	28 mm
Outer Diameter	32 mm
Bearing Type	metal with bronze
Shaft Dia., Nominal (d)	28.0000
Shaft Size (ds) - 28 +0 / -0.033	28 +0 / 0.033
Housing Bore Dia. (Dh) - 32 +0.025 / -0	32 +0.025 / 0
Bearing Outside Diameter, Nominal(Do)	32.000
Bearing Bore after Mounting (di)	28 +0.185 / +0.040
Average Clearance (Cd)	0.1280
Wall Thickness (S3)	1.950
Bearing Length, Nominal (B)	40.000
Bearing Length Tolerance (B tol.) - +0 / -0.40	+0 / 0.40
OD Chamfer Length (Co)	1.200
ID Chamfer Angle (B deg.)	35
ID Chamfer Length (Ci)	0.500