

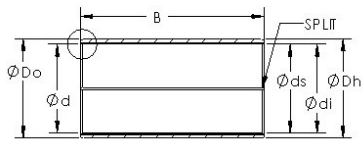

ISO BEARING-SINGAPORE (PTE)LTD.

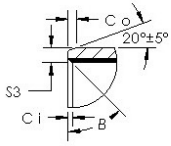

AST AST850BM 2425 plain bearings

Bearing No. AST850BM 2425

AST850BM 2425 Bearing 2D drawings and 3D CAD models

Bore Diameter	24 mm
Outer Diameter	27 mm
Bearing Type	metal with bronze
Shaft Dia., Nominal (d)	24.0000
Shaft Size (ds) - 24 +0 / -0.033	24 +0 / 0.033
Housing Bore Dia. (Dh) - 27 +0.021 / -0	27 +0.021 / 0
Bearing Outside Diameter, Nominal(Do)	27.000
Bearing Bore after Mounting (di)	24 +0.161 / +0.020
Average Clearance (Cd)	0.1070
Wall Thickness (S3)	1.460
Bearing Length, Nominal (B)	25.000
Bearing Length Tolerance (B tol.) - +0 / -0.40	+0 / 0.40
OD Chamfer Length (Co)	0.700
ID Chamfer Angle (B deg.)	35
ID Chamfer Length (Ci)	0.500