

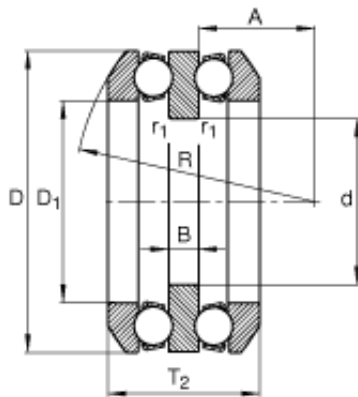

## ISO BEARING-SINGAPORE (PTE)LTD.



35 mm x 73 mm x 9 mm FAG 54209 thrust ball bearings

Bearing No. 54209

54209 Bearing 2D drawings and 3D CAD models

Size	35x73x39.6 mm
Bore Diameter	35 mm
Outer Diameter	73 mm
Width	39,6 mm
d	35 mm
D	73 mm
T <sub>2</sub>	39,6 mm
A	23 mm
B	9 mm
D <sub>1</sub>	47 mm
D <sub>a max</sub>	60 mm
d <sub>a max</sub>	45 mm
R	56 mm
r <sub>1 min</sub>	0,6 mm
r <sub>a max</sub>	1 mm
r <sub>a1 max</sub>	0,6 mm
r <sub>min</sub>	1 mm
m	0,537 kg / Weight
C <sub>a</sub>	39000 N / Dynamic load rating (axial)
C <sub>0a</sub>	80000 N / Static load rating (axial)
A	0,043 / Factor min. load
n <sub>G</sub>	5500 1/min / Limiting speed
C <sub>ua</sub>	3550 N / Fatigue limit load,



# ISO BEARING-SINGAPORE (PTE)LTD.

	axial
--	-------