

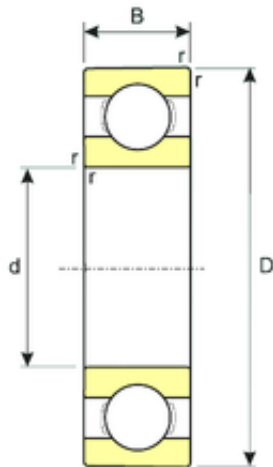

ISO BEARING-SINGAPORE (PTE)LTD.



15 mm x 32 mm x 9 mm ISB 6002 deep groove ball bearings

Bearing No. 6002

Size	15x32x9 mm
Bore Diameter	15 mm
Outer Diameter	32 mm
Width	9 mm
d	15 mm
D	32 mm
B	9 mm
C	9 mm
Weight	0,03 Kg
Basic dynamic load rating (C)	5,7 kN
Basic static load rating (C0)	2,8 kN
(Grease) Lubrication Speed	24480 r/min

6002 Bearing 2D drawings and 3D CAD models