

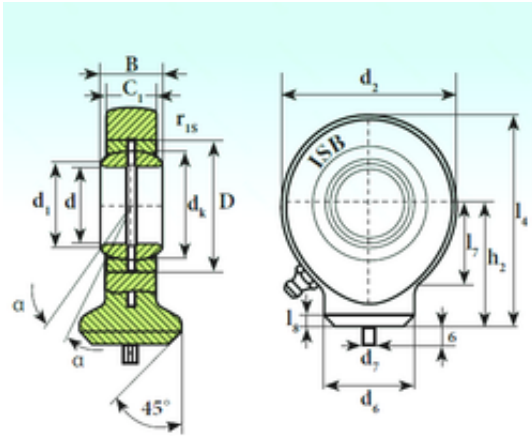

ISO BEARING-SINGAPORE (PTE)LTD.



80 mm x 120 mm x 55 mm ISB T.A.C. 280 plain bearings

Bearing No. T.A.C. 280

T.A.C. 280 Bearing 2D drawings and 3D CAD models

Size	80x120x55 mm
Bore Diameter	80 mm
Outer Diameter	120 mm
Width	55 mm
d	80 mm
D	120 mm
B	55 mm
d7	6 mm
d1	89,4 mm
d2	180 mm
d6	95 mm
dk	105 mm
h2	141 mm
l4 max.	231 mm
l7 min.	98 mm
l8	5 mm
r min.	1 mm
C1	47 mm
Angle	6 °
Weight	8,7 Kg
Basic dynamic load rating (C)	400 kN